

HATCH EXPOSED MIXERS

Product Name: EXPOSED SHATTAF/SHOWER MIXER
Model Number: HAT-MX057



AGAINST MANUFACTURING DEFECTS



SERVICE & ACCESSORIES

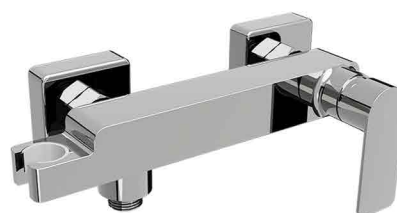
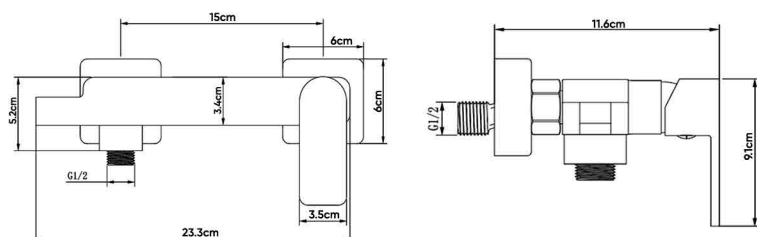

AVAILABLE COLORS



GLOSSY CHROME
SW-60196814



MATTE BLACK
SW-60196815



BRUSHED NICKEL
SW-60196816



GLOSSY GOLD
SW-60196817



BRUSHED GOLD
SW-60196818



BLACK TITANIUM
SW-60196819

DESCRIPTIONS

Material: Brass main body, frame material: Stainless steel (SUS 304)
Shape: Square
Packaging unit: 1 piece

TECHNICAL SPECIFICATION

Average Flow rate: 13.5 L/min
Maximum operating pressure: 15 bar
Mounting type: Exposed
Connection size: G 1/2 in
Decorative ring thickness: 0.8 mm
Ceramic cartridge:
Non-scratch protector
Distance between water supply hole: ± 12 mm
Uses as: Shattaf Mixer and Shower Mixer

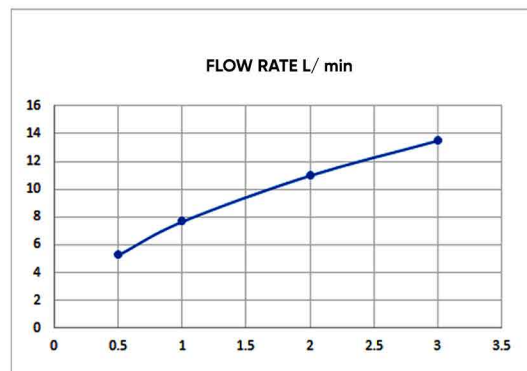

DIMENSIONS

9.1 x 11.6 x 23.3 CM

APPLICATIONS

Bathroom

BOX COMPONENTS

- Brass Mixer
- Handle
- (SUS 304) Frame
- (SUS 304) S-union sets
- (SUS 304) Screws
- Silicon & Rubber
- Non-return valve
- Allen key

COUNTRY OF ORIGIN

Made in China for HATCH Sanitary

WARRANTY

7 years against manufacturing defects
 2 years for service and accessories



HATCH SANITARY

Hatch Sanitary is a trademark owned by MHG

Old Al Kharj Road, Building No. 3533
 Riyadh 14511 - 8305
 Kingdom of Saudi Arabia

info.mhg@marketing-home.com

800 122 2230